

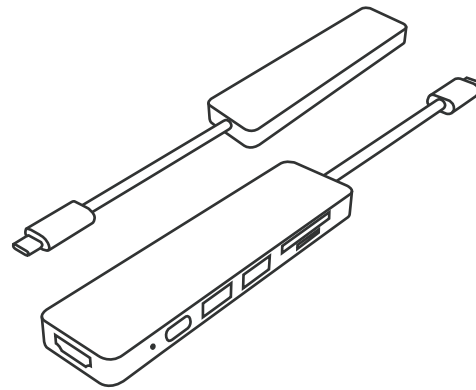

USB Type-C Hub Pro

Product Model:UCN3286



USER MANUAL

FC CE RoHS
Made in China

1. Features

- Plug&Play
- HDM: Up to 3840*2160@30Hz
- USB C PD: Power Input Up to 100W
- USB 3.0 x2/ Up to 5Gbps
- SD/TF: Up to 2TB capacity
- Preventing overload, over-voltage, over-current, short circuit, overcharge, voltage regulation and temperature protection under 45 °C.

2. Specifications

Input port: USB-C/M x1
USB C PD
Output port: HDMI/F x1
USB 3.0/F x2
SD/TF Card Slot

Operating Temperature: 0°C to +45°C
Operating Humidity: 10% to 90% RH
Storage Temperature: -10 °C to +70°C
Storage Humidity: 10% to 90% RH

3. Instruction to Product Ports

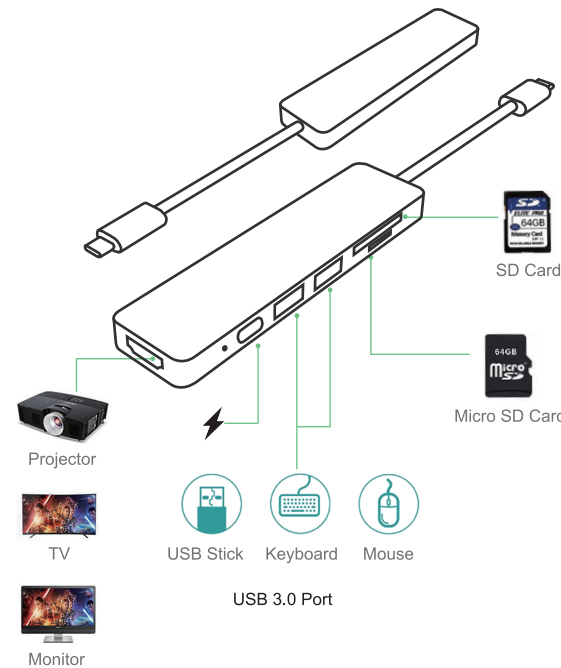

4. Attention:

- The current output of the new MacBook is around 1.5A.When the load exceeds 1 .5A,the computer will start the Self-Protection function. Then prompt pop up(current overload),disable the prompt and restart your laptop. Connect the PD before plugin any other port.
- Please do not disconnect the PD when transferring data.

5. FAQ

Q1: Why is there no video output?

- A1: a.Please make sure that the laptop is equipped with Thunderbolt 3/USB-C 3.1 Gen 2/USB-C 3.1 Gen 1 port (Supports PD), which supports usb c display transfer.
b.If it is Thunderbolt 3 laptop, please try to update system BIOS, Thunderbolt 3 driver, Thunderbolt 3 NVM firmware,and graphics (GPU) driver from the system manufacturer.
c.Ensure sufficient power supply to connect external monitors.
d.Check the HDMI cable or monitor if can work properly.

Q2: Why can't I use the mouse/keyboard/hard drive via the product?

- A2: Please plug in the Laptop's power adapter to the USB-C PD port or connect the AC power adapter to the laptop before using. If the issue insists, please feel free to contact us.

Q3: Why does the USB C PD port doesn't work?

- A3: The USB C PD supports power INPUT up to 100W. Please plug in the Laptop's power adapter to the USB-C pd port and make sure the laptop supports PD function.

6. Any Concern?

Product Support:

Email: hiearcool@outlook.com